

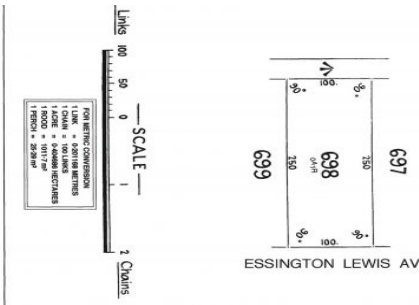

Peter Calliss
REAL ESTATE



71 Essington Lewis Avenue Whyalla SA

Situated along a fast developing strip of boutique retail outlets, convenience stores and international dining both indoors and outdoors ? 71 Essington Lewis Avenue is an ideal blank canvas with great exposure in a good residential location, walking distance of the Whyalla Hospital, the Whyalla Foreshore and popular schools and sporting grounds? basically 71 Essington Lewis Avenue is less than 10 minutes drive to and from anywhere in Whyalla.

The property is Zoned Local Activity Centre with a land size of 1000 sqm.

RLA 2154

Price : \$165,000

View : <https://www.petercalliss.com.au/sale/sa/eyre-peninsula/whyalla/residential/land/7614020>

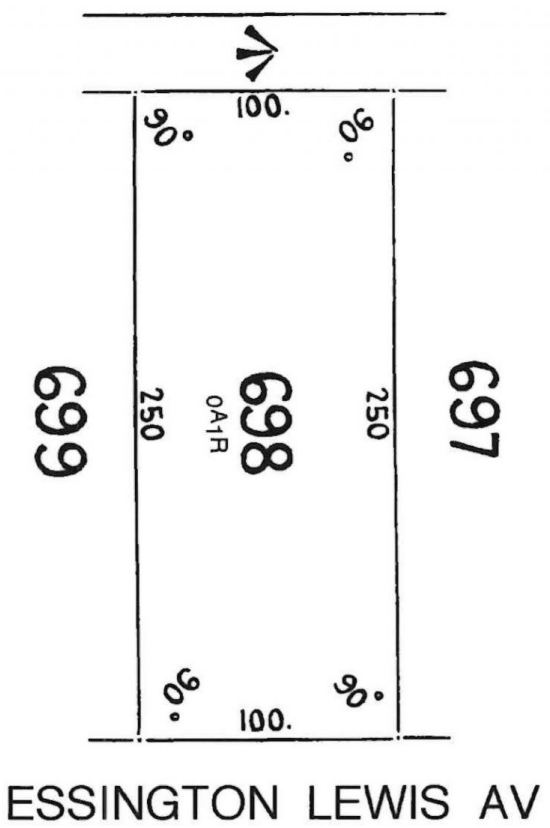

FOR METRIC CONVERSION	
1 LINK	= 0.201168 METRES
1 CHAIN	= 100 LINKS
1 ACRE	= 0.404686 HECTARES
1 ROOD	= 1011.7 m ²
1 PERCH	= 25.29 m ²